

| REV. | DESCRIPTION | DRAWN         | CHECKED | APPROVED |
|------|-------------|---------------|---------|----------|
| A    | NEW RELEASE | LJC 06/22/06' |         |          |
|      |             |               |         |          |
|      |             |               |         |          |

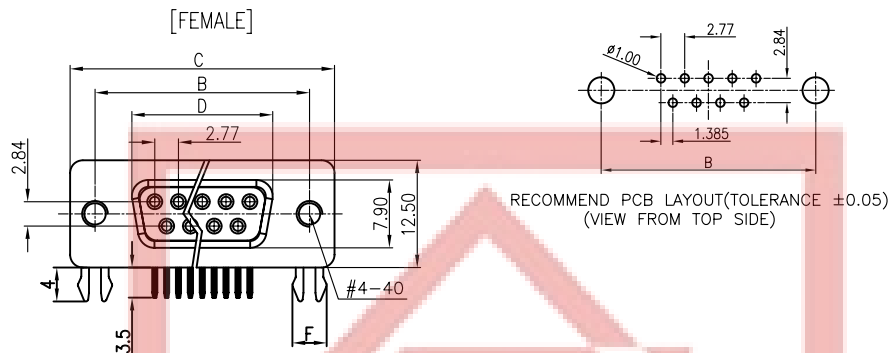

NOTES:

1. PRODUCTS PERFORMANCE:

- 1.0 VOLTAGE RATING: 250V AC.
- 1.1 CONTACT CURRENT RATING: 1.5A MAX. PER PIN.
- 1.2 CONTACT RESISTANCE: 20mΩ MAX.
- 1.3 DIELECTRIC WITHSTANDING VOLTAGE: 500V AC(rms) FOR 1 MINUTE.
- 1.4 INSULATION RESISTANCE: 1000MΩ MINI.
- 1.5 OPERATING TEMPERATURE: -20°C~+70°C.

2. PRODUCT NUMBER CODE:

DS1037-01 - X X X X X X X X

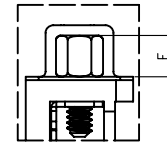

WITH SCREW TYPE

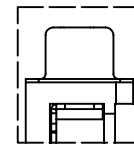

WITH RIVET TYPE



WITH SCREW AND RIVET TYPE

- SCREW DIM. E  
4: 4.80mm  
5: 5.80mm
- BOARD LOCK DIM. F  
4: 4.00mm  
7: 3.70mm
- CONTACT PLATING  
T: SELECTIVE GOLD FLASH  
Si: FULL GOLD FLASH
- COLOR OF HOUSING  
K: BLACK  
B: BLUE
- SCREW TYPE  
A: WITH SCREW TYPE  
B: WITH RIVET TYPE  
C: WITH SCREW AND RIVET TYPE
- SHELL PLATING  
N: Nickel  
T: Tin
- CONNECTOR TYPE  
M: MALE  
F: FEMALE
- No. OF CONTACT  
09: 9pos.  
15: 15pos.  
25: 25pos.  
37: 37pos.

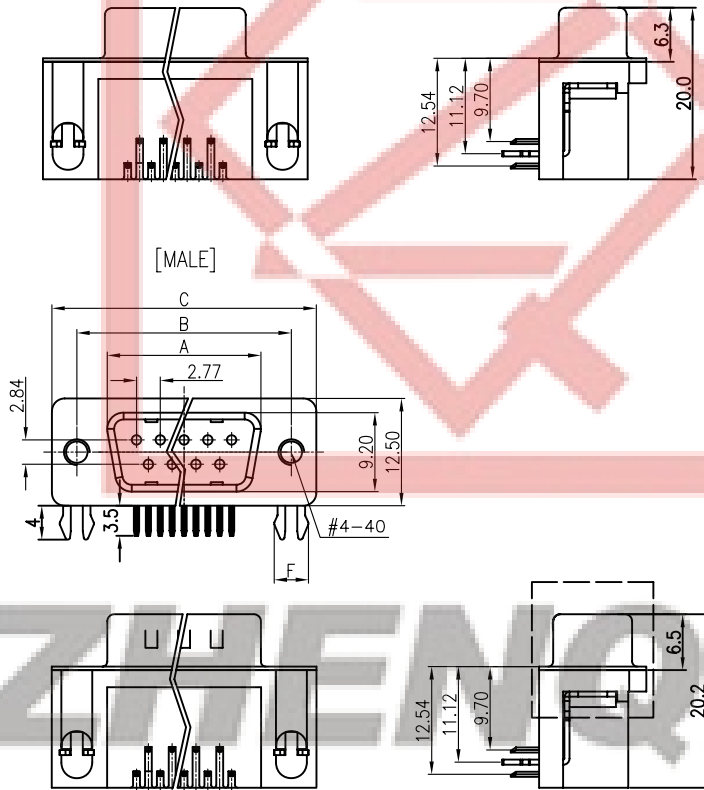

Dimension

| Position | A±0.2 | B±0.2 | C±0.2 | D     |
|----------|-------|-------|-------|-------|
| 9        | 17.90 | 24.99 | 30.80 | 16.33 |
| 15       | 26.50 | 33.32 | 39.14 | 24.66 |
| 25       | 40.00 | 47.04 | 53.04 | 38.38 |
| 37       | 56.50 | 63.50 | 69.32 | 54.84 |

|                   |       |                     |     |  |       |                               |                  |
|-------------------|-------|---------------------|-----|--|-------|-------------------------------|------------------|
| GENERAL TOLERANCE |       | ANGLE TOLERANCE     |     | PROJECTION   | TITLE | D-SUB RIGHT ANGLE(9.4mm) TYPE |                  |
| X.                | ±0.60 | X.                  | ±5' | UNITS  | mm    |                               |                  |
| .X                | ±0.38 | .X                  | ±3' | SHEET SIZE   | A4    | SERIES                        | DS1037-01 SERIES |
| .XX               | ±0.25 | .XX                 | ±2' | Add: West Zhenqin Town Cixi Ningbo China               |       |                               |                  |
| DRAWING TYPE      |       | CUSTOMER            |     | <b>宁波正青电子有限公司</b><br>NINGBO ZHENQIN ELECTRONIC CO. LTD |       |                               |                  |
| SCALE             |       | 1:1 SHEET 1 OF 1    |     |  |       |                               |                  |
| DRAWING NO.       |       | C-DS1037-01-XXXXXXX |     |  |       |                               |                  |